

UTILITY SHEDS

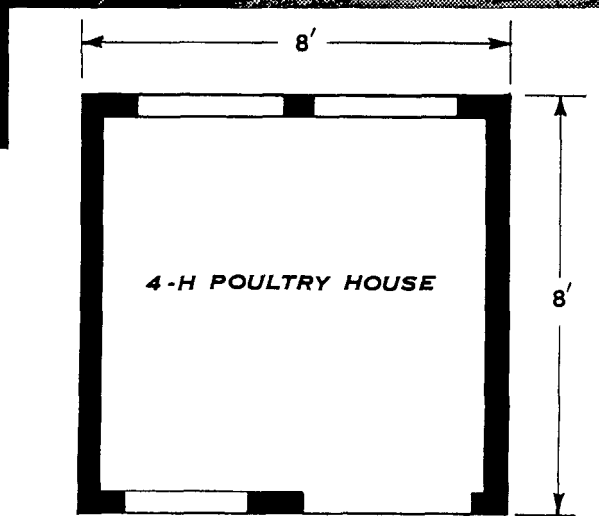
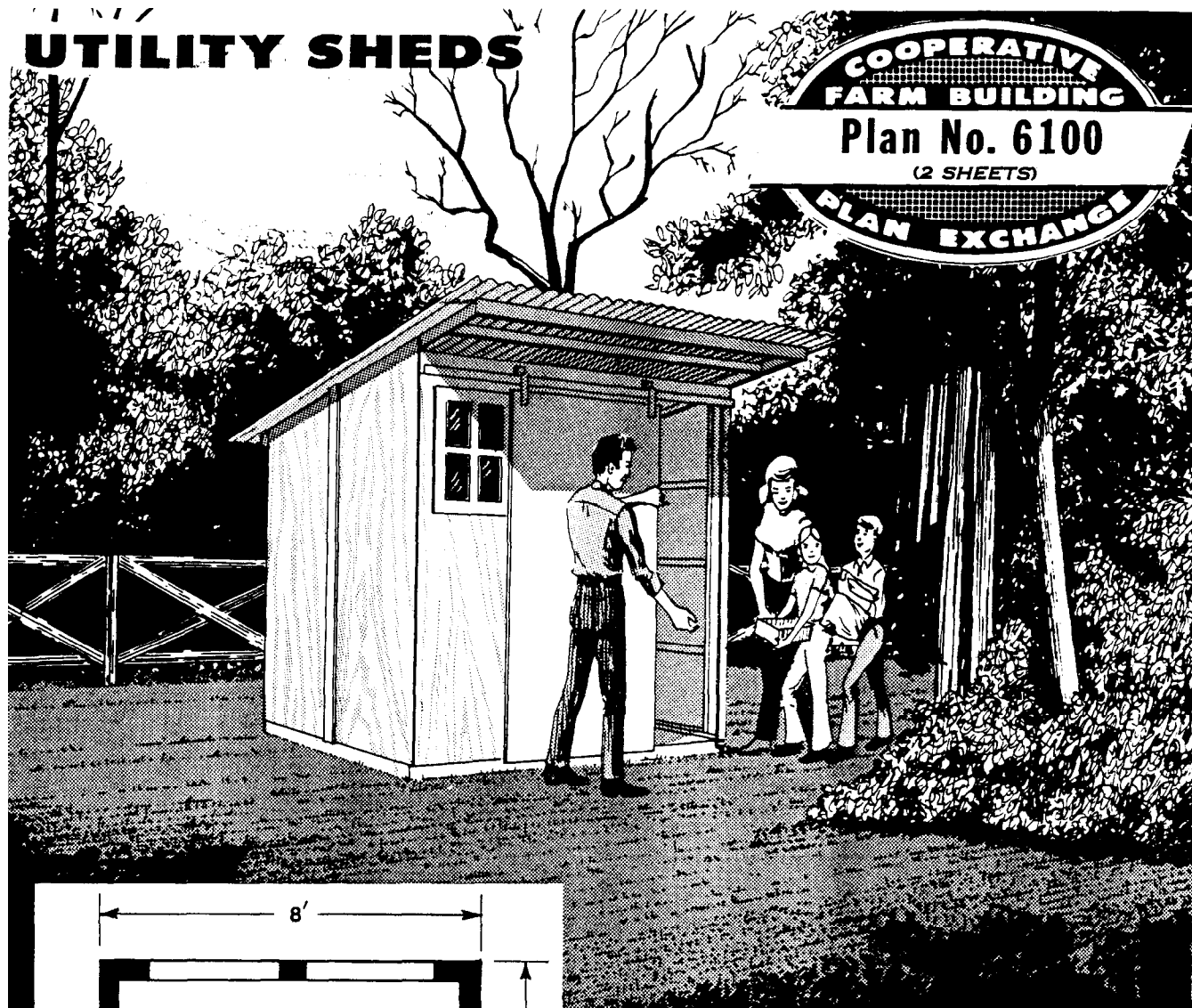

Working drawings for the sheds include a list of materials needed for construction.

The plan is for panel-type construction: The 2-by-4 framing is covered with exterior-type plywood panels and is secured to a 4-inch-thick concrete-floor slab with two anchor bolts per panel.

In some areas, building permits are required for this type structure. Consult your local building authorities before starting construction.

Complete working drawings may be obtained from the extension agricultural engineer at your State university. There may be a small charge to cover cost of printing.

If you do not know the location of your State university, send your request to Agricultural Engineer, Extension Service, U.S. Department of Agriculture, Washington, D.C. 20250. He will forward your request to the correct university.

The plan for the utility shed illustrated above was developed at the University of Connecticut, Storrs. The shed is one of many different designs, some of which are shown on the back page of this sheet.

ORDER PLAN NO. 6100, UTILITY SHEDS.

WASHINGTON, D.C.

ISSUED JULY 1971

UNITED STATES DEPARTMENT OF AGRICULTURE

Miscellaneous Publication No. 1196

For sale by the Superintendent of Documents, U.S. Government Printing Office, Washington, D.C. 20402—Price 5 cents.

Stock Number 0100-1350

Alternate Plans

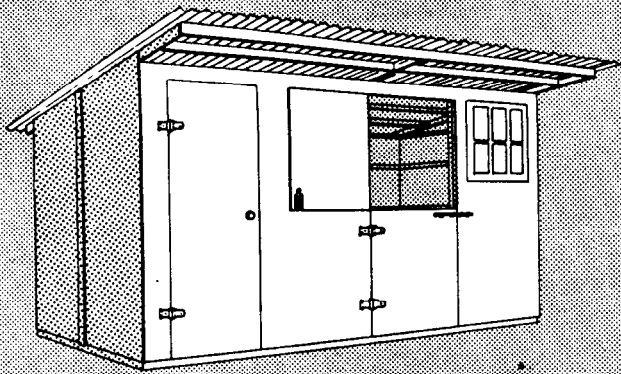

HORSE STALL

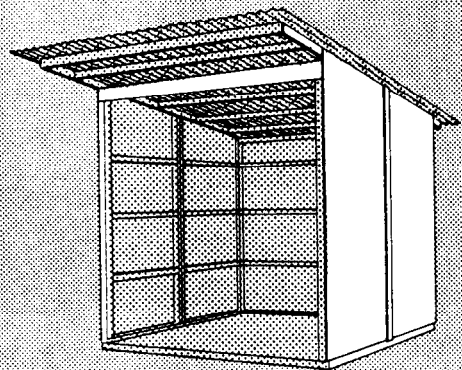
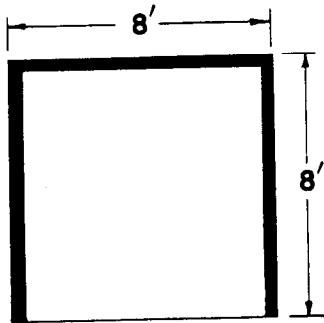
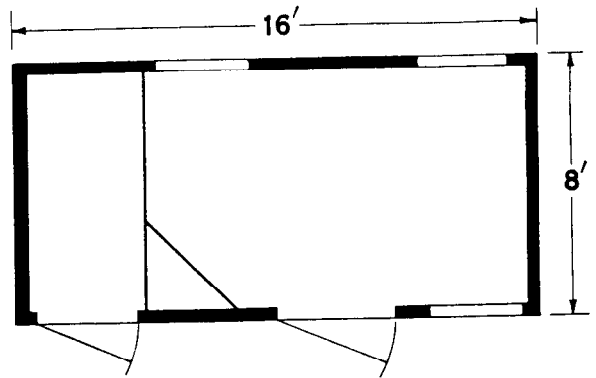

OPEN SHED

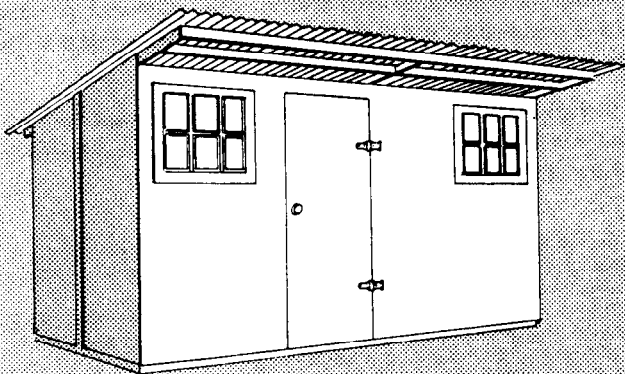

SHOP

